

CORAL SEA
(SOUTH PACIFIC OCEAN)

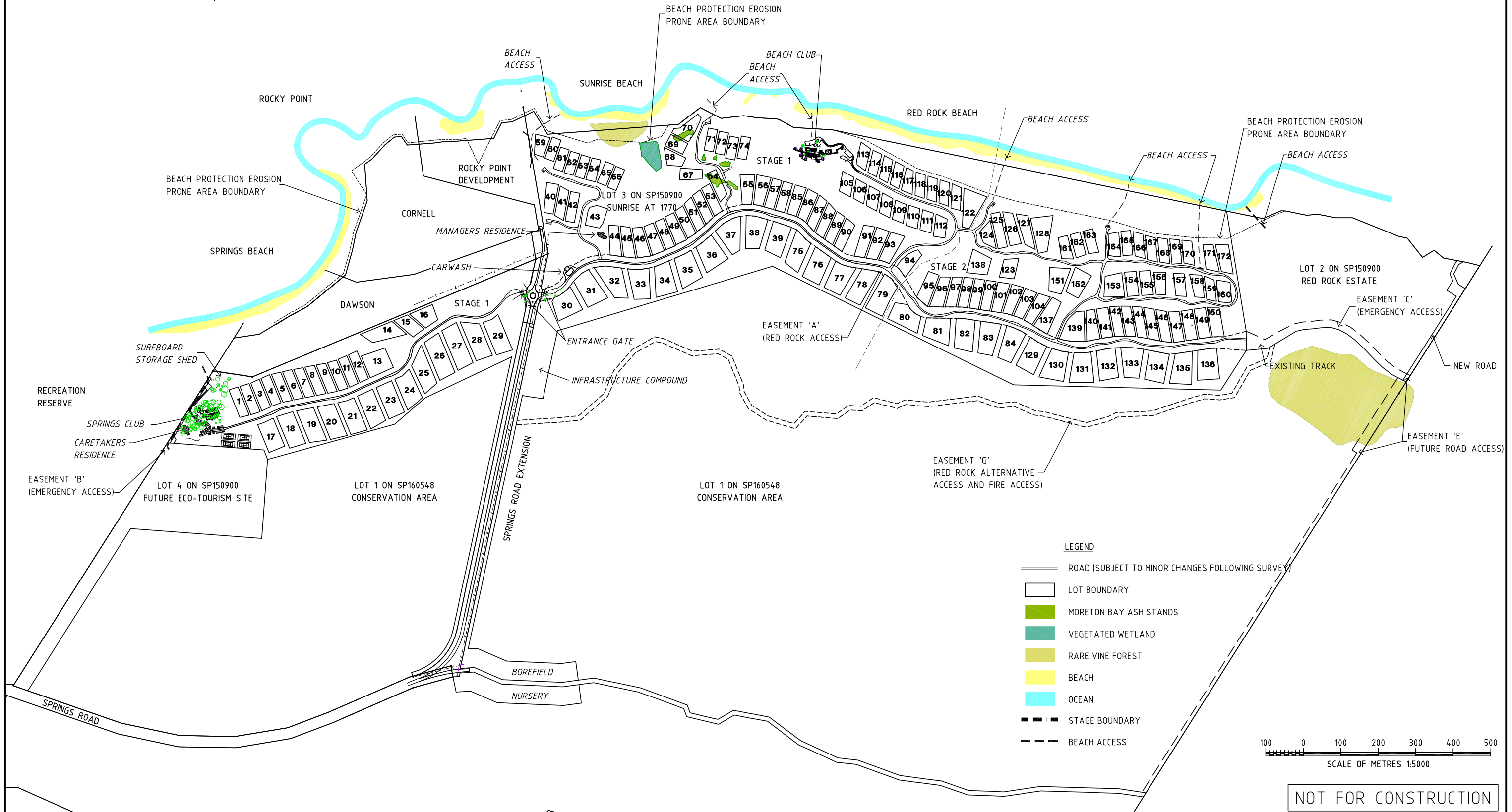

LEGEND

- ROAD (SUBJECT TO MINOR CHANGES FOLLOWING SURVEY)
- LOT BOUNDARY
- MORETON BAY ASH STANDS
- VEGETATED WETLAND
- RARE VINE FOREST
- BEACH
- OCEAN
- STAGE BOUNDARY
- BEACH ACCESS

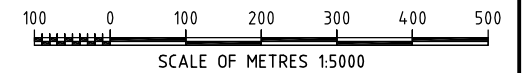

NOT FOR CONSTRUCTION

CLIENT:
SUNRISE AT 1770
LEVEL 3, 20 PARK ROAD
MILTON, QLD
AUSTRALIA 4064

NOTES

© Kellogg Brown & Root Pty Ltd

REV	DATE	DRAWN	DRAFT	ENG	TECH	PROJECT	DESCRIPTION
12	10.06.04	YJF	CJS	-	-	AWS	LOTS 138-141 AND 151-155 AMENDED, ROAD 12 REMOVED
11	30.03.04	YJF	CJS	-	-	AWS	LOTS 124, 159-172 AND ROAD 11 AMENDED, EASEMENT 'H' REMOVED
10	6.11.03	YJF	CJS	-	-	AWS	EASEMENT 'H' AND RED ROCK ACCESS ADDED, GENERAL AMENDMENTS
9	7.10.03	YJF	CJS	-	-	AWS	STAGE 2 ROADS AMENDED
8	16.06.03	CJS	YJF	-	-	AWS	BEACH CLUB DESIGN UPDATED

ENGINEERING APPR.	DATE
-	-
TECHNICAL APPR.	DATE
-	-
PROJECT APPR.	DATE
A.SHARMAN	16.06.03
CLIENT APPR.	DATE
-	-

50mm ON ORIGINAL DRAWING

Kellogg Brown & Root Pty Ltd

KBR

Kellogg Brown & Root Pty Ltd ABN 91 007 660 317
Level 1, 25 Sturt Street
Townsville QLD 4810

DRAWING SCALE: 1:5000

PROJECT No.: TEV201.100

CAD FILE Name

TITLE	DRAWING No.	REVISION
SUNRISE AT 1770 STAGE 1 & 2 INFRASTRUCTURE DEVELOPMENT PLAN	TEV201.100-DJ-001	12